



AKTEA RESIDENCES 4

LIMASSOL



AKTEA IV

ON THE WORLD'S DOORSTEP

OUR DESTINATION DEVELOPMENTS



CURRENT PROJECTS:

- 1 Trilogy Limassol Seafront
- 2 Aktea Residences 4
- 3 Thalassa Residences
- 4 Limassol Marina
- 5 Limassol Greens Golf Resort
- 6 Seaview Heights
- 7 Akamas Bay Villas
- 8 Attikis Residences
- 9 Park Residences

AKTEA RESIDENCES 4

An address for coastal living, situated in one of Limassol's up-and-coming areas, Aktea Residences 4 combines eclectic design ingredients and luxury materials for a Mediterranean lifestyle in an urban setting.

- Boutique development of 24 luxury apartments.
- 1 and 2-bedroom apartments, with large terraces and communal swimming pool.
- Walking distance to Kolonakiou Avenue and a short drive to the city centre, the promenade, amenities and services.

THE LOCATION

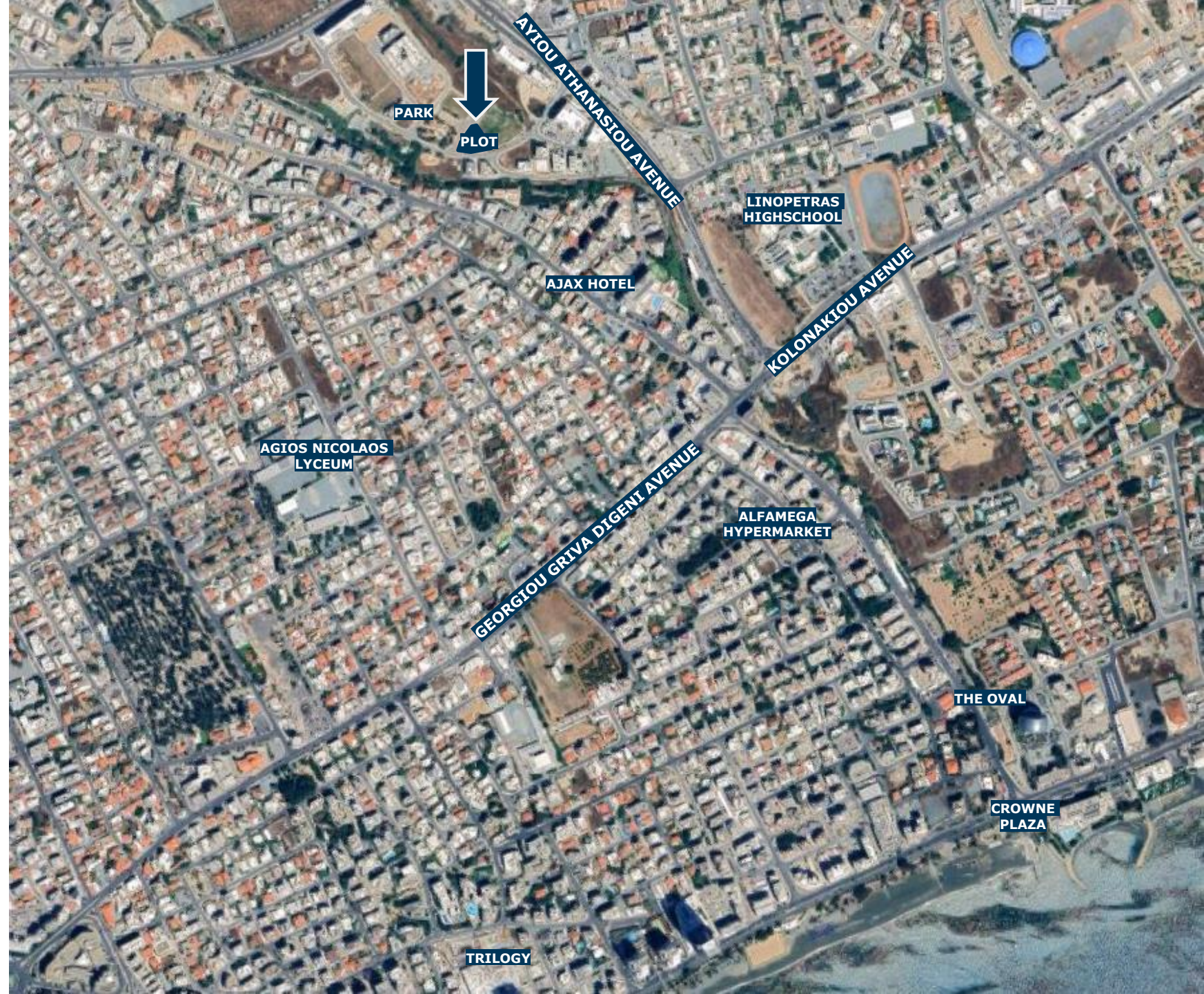



GROUND FLOOR

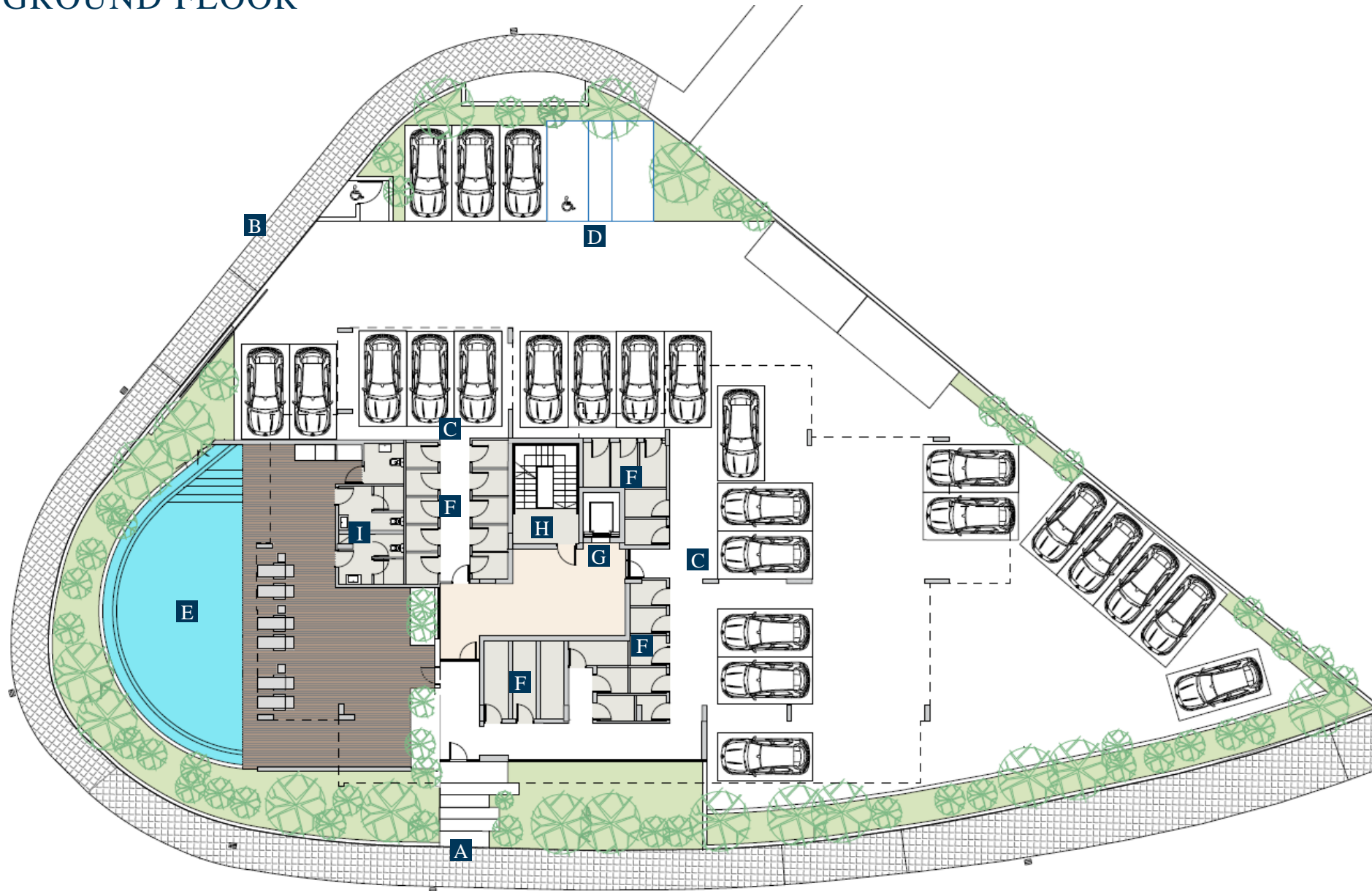

- A. Pedestrian entrance
- B. Parking entrance & exit
- C. Building entrance
- D. Disabled parking space
- E. Communal swimming pool
- F. Storerooms
- G. Lift
- H. Staircase
- I. Shower, changing rooms & WC

1ST, 2ND, 3RD & 4TH FLOOR



SCHEDULE OF AREAS

Apt No.	Floor No.	No. of Bedrooms	Covered Internal Area m ²	Covered Terraces m ²	Total Covered Area m ²	Common Area m ²
101	1st	2	87	28	115	13
102	1st	2	87	27	114	13
103	1st	2	87	20	107	13
104	1st	2	87	19	106	13
105	1st	1	51	10	61	8
106	1st	1	51	14	65	8
201	2nd	2	87	28	115	13
202	2nd	2	87	27	114	13
203	2nd	2	87	20	107	13
204	2nd	2	87	19	106	13
205	2nd	1	51	10	61	8
206	2nd	1	51	14	65	8
301	3rd	2	87	28	115	13
302	3rd	2	87	27	114	13
303	3rd	2	87	20	107	13
304	3rd	2	87	19	106	13
305	3rd	1	51	10	61	8
306	3rd	1	51	14	65	8
401	4th	2	87	28	115	13
402	4th	2	87	27	114	13
403	4th	2	87	20	107	13
404	4th	2	87	19	106	13
405	4th	1	51	10	61	8
406	4th	1	51	14	65	8

SPECIFICATIONS

- All common internal areas will be paved with marble
- The entrance hall, living and dining area, kitchen, corridors, bathrooms and terraces will be paved with ceramic tiles
- The bedrooms will be paved with natural pre-varnished wood parquet with real wood veneer top layer
- Imported kitchen, wardrobes and internal doors
- Pre-fitted with kitchen appliances
- Full installation of VRV (heating and cooling)
- Underfloor central heating
- Decorative vertical shading panels on the terraces
- Video entry phone-controlled entrance doors
- Electric water heater and pressure system
- Electrically operated control gate for the car parking entrance
- Full installation of individual security alarm system with motion sensors
- Provision for CCTV on the ground floor at the perimeter of the building and electric cars' charging



CYBARCO

Thank you.
Please feel free to get in touch.

CYBARCO.COM

Disclaimer

This presentation does not constitute an offer and is not a legally binding document.

It merely aims to provide information on the materials it describes. Any details mentioned serve as guidelines only.

Images used are indicative and specifications are subject to change.

The indicative floorplans are for marketing purposes only. Refer to the architectural drawings for more accurate information.